



Serie/Series

D

Giunti rotanti doppio passaggio indipendente
Dual flow independent rotary union



D

SERIES

DUAL FLOW INDEPENDENT ROTARY UNION *Giunti rotanti doppio passaggio indipendente*

The standard supply provides the rotating nipple threaded cylindrical GAS. On the request we supply other standard. Standard seal (graphite vs. stainless steel) in used for air and for water or hydraulic oil, seal of silicon carbide vs. silicon carbide in suggested. For liquid at pressure more than 60 bar (870 PSI) please contact our technician

La fornitura standard comprende il rotore con filettatura cilindrica GAS. Su richiesta forniamo rotori filettati secondo altri standard. La tenuta standard (grafite su acciaio Inox) si utilizza per aria e per acqua con filtraggio pari ad almeno 20 micron. Per liquidi con pressioni superiori a 60 bar si consiglia di consultare un nostro tecnico.

MAX FLUID PRESS

AIR - WATER - OIL - FLUIDS 12 bar
VACUUM 700 mm/hg

MAX SPEED

AIR - WATER - OIL - FLUIDS 2.500 rpm
Above 1.000 rpm contact Tech Dept

MAX TEMPERATURE

AIR - WATER - OIL - FLUIDS
100 °C

1

FLANGED VERSION
Versione attacco a flangia

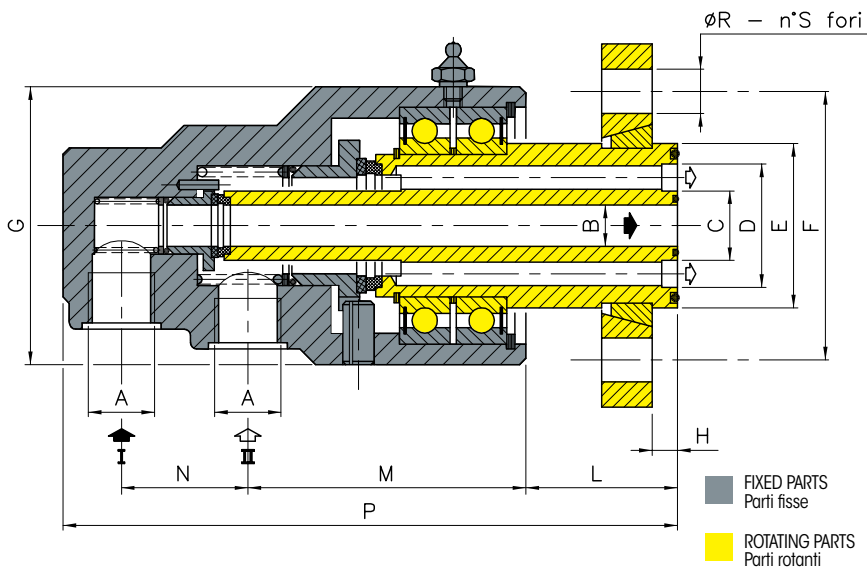

2

THREAD VERSION
Versione attacco filettato

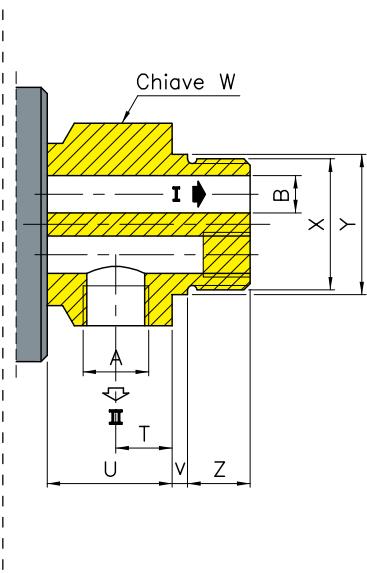

1 FLANGED VERSION

GRAPHITE-INOX Grafito-Inox	SILICON-SILICON Silicio-Silicio	A	B	C	D	E	F	G	H	L	M	N	P	R	S
D-0025-GY3LS	D-0025-GY2LS	1/4" BSP	6 0.236	12,5 0.492	22 0.866	36 1.417	65 2.559	60 2.362	6 0.236	43 1.693	62 2.441	30 1.181	148 5.827	14 0.551	4
D-0037-GY3LS	D-0037-GY2LS	3/8" BSP	10 0.394	17 0.669	30 1.181	45 1.772	75 2.953	75 2.953	8 0.315	48 1.890	78 3.071	38 1.496	178 7.008	14 0.551	4
D-0050-GY3LS	D-0050-GY2LS	1/2" BSP	13 0.512	22 0.866	39 1.535	52 2.047	85 3.346	88 3.465	8 0.315	48 1.890	88 3.465	40 1.575	194 7.638	14 0.551	4
D-0075-GY3LS	D-0075-GY2LS	3/4" BSP	18 0.709	26 1.024	44 1.732	58 2.283	100 3.937	94 3.701	10 0.394	57 2.244	93 3.661	48 1.890	224 8.819	18 0.709	4
D-0100-GY3LS	D-0100-GY2LS	1" BSP	24 0.945	33 1.299	53 2.087	65 2.559	100 3.937	110 4.331	10 0.394	57 2.244	100 3.937	58 2.283	246 9.685	18 0.709	4

2 THREAD VERSION

GRAPHITE-INOX Grafito-Inox	SILICON-SILICON Silicio-Silicio	A	B	T	U	V	Z	W	X	RPM G/min
D-D025-GY3GS	D-D025-GY2GS	1/4" BSP	6 0.236	11 0.433	23 0.906	4 0.157	14 0.551	36	3/4" BSP	1.000
D-D037-GY3GS	D-D037-GY2GS	3/8" BSP	10 0.394	13 0.512	30 1.181	4 0.157	18 0.709	55	1" BSP	1.000
D-D050-GY3GS	D-D050-GY2GS	1/2" BSP	13 0.512	18 0.709	40 1.575	5 0.197	22 0.866	65	1" 1/4 BSP	1.000
D-D075-GY3GS	D-D075-GY2GS	3/4" BSP	18 0.709	21 0.827	51 2.008	6 0.236	25 0.984	70	1" 1/2 BSP	1.000
D-D100-GY3GS	D-D100-GY2GS	1" BSP	24 0.945	25 0.984	56 2.205	8 0.315	28 1.102	90	2" BSP	1.000

For left thread, the third letter of code change replacing "D" with "S"
Per filettature sinistre, la terza lettera del codice varia sostituendo "D" con "S"



INSTALLATION
Installazione

HOW TO INSTALL // COME INSTALLARE

1

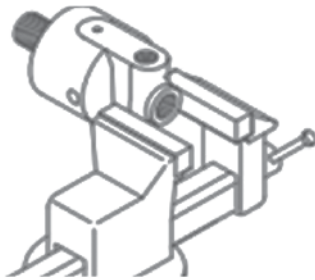

2

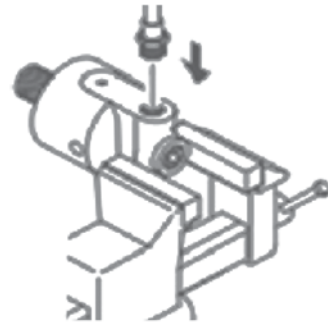

3



4

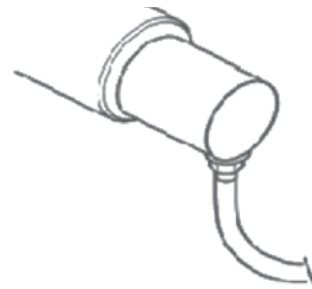

HOW TO NOT INSTALL // COME NON INSTALLARE

1

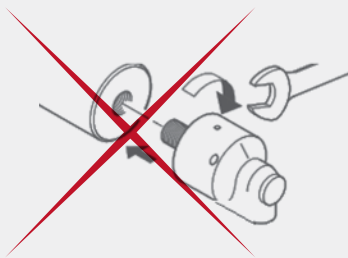

2



3

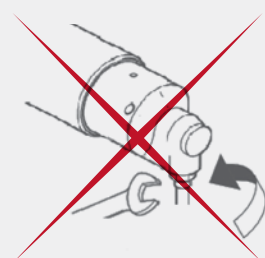

PIPES MUST BE FLEXIBLE!
ITUBI DEVONO ESSERE FLESSIBILI